

**Additional**

**BASEMENT LEVEL  
+/- 3,554 Square Feet**

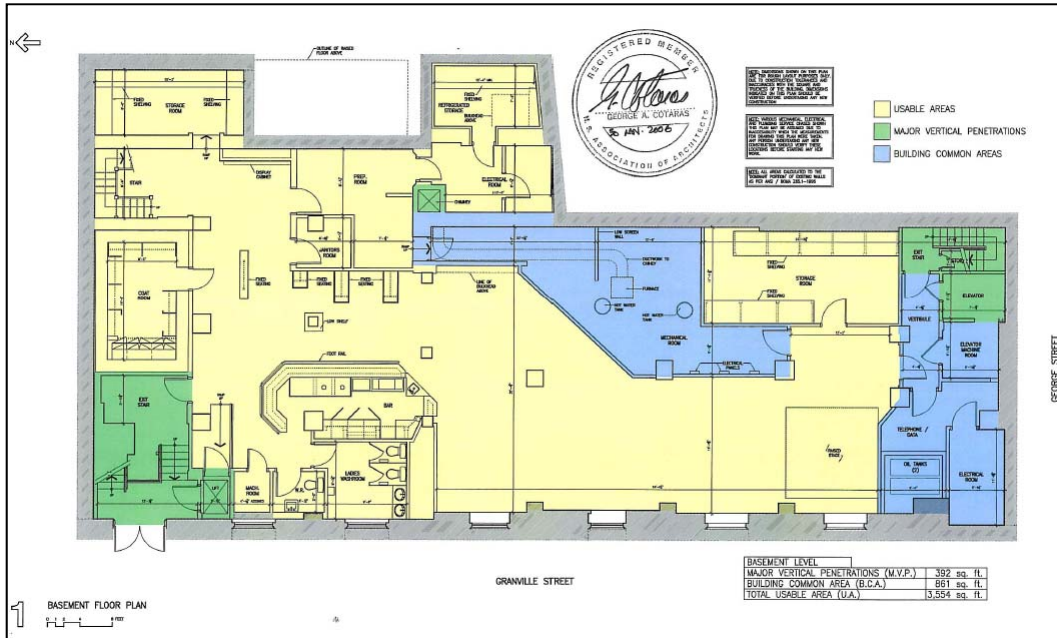

**Contact**



**Jonathan Hartlen**  
(902) 482-9201  
(902) 209-9619 cell  
jhartlen@compassbroker.com

3770 Kempt Rd  
Suite 110  
Halifax, NS, B3K 4X8

**902.454.1234**  
www.compassbroker.com